

SENSOR TIP OPTIONS

Custom Tips To Customer Specifications

For 90° tips, specify Options T4 thru T6 to designate custom requirements.

- For the small probes, Option T4 turns 90° in the shortest space
- For large probes, Options T5 & T6 turn 90° in the shortest space

■ Option T5 - 90° Tip

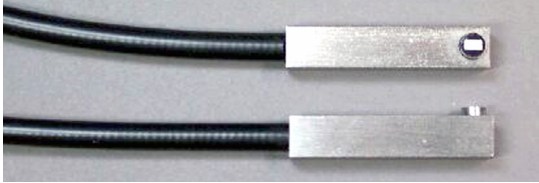

Use **T5** to designate a right angle tip with square body construction having a short sensor tip section mounted at 90°. This design often turns 90° in the shortest space possible. Specify dimensions shown.

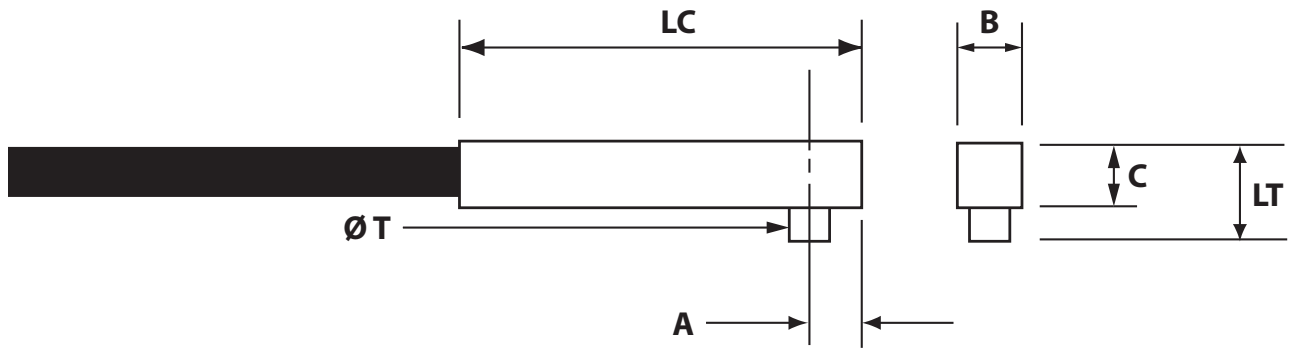

MINIMUM REQUIRED DIMENSIONS FOR T5 TIPS (mm)						
MODEL	LC	$\varnothing T$	A	B	C	LT
D6, D12, D20, D21, RC12 - RC22	12.7	0.81	0.75	4	4	5.5
D47, RC32	12.7	1.65	1.25	4	4	6
RC25	12.7	4.75	3	6.35	6.35	9
RC60, D63, D64	20	1.83	1.2	4	6.35	9
D100, RC99, RC100	20	3.18	2	6.35	8	10.5
RC62, RC63	25	4.75	3	6.35	8	10.5
D125	25	3.96	2.5	6.35	10	12.5
D169, D170, D171, RC171	30	4.75	3	8	25	35
RC90, RC190	30	7.92	4.5	8	25	35
D240, RC290	40	7.92	4.5	10	30	40